



ALPHA⁸²

MODULAR TRUSS SYSTEM



WORLDWIDE PATENT

Opening new doors

ALPHA82 is a brand-new patented truss system that you can configure to the job ahead. The unique ALPHA connectors can be connected to expertly designed ALPHA ladder trusses (sizes L52 and XL101) to form a 3D truss with similar strength compared to standard trusses with the same dimensions.

The ALPHA connector contains M12 size slots on all 4 sides enabling you to connect accessories such as lifting eyes, clamps, brackets, curtain tracks, trolley beams, braces and/or machinery.



Available in **two sizes**

Connectable to existing **L52S** and the **XL101R** truss
Available in 4 standard lengths:
50 cm, 100 cm, 200 cm and 300 cm.





Endless possibilities

Once delivered, you can assemble, configure, and let your creativity run free, using either our 'standard' ALPHA connector or your own configuration to create the shape you need. You can easily adjust your 52 truss from 30 cm width up to 80 cm width with just a couple of bespoke ALPHA connectors and no further investment in truss parts. This results in a much more flexible inventory than your competitors, a lower storage cost due to less warehouse space and, ultimately, a better ROI.



L52 Single



XL101 Single



I Beam



Stackable Truss



L52 Vertical Stacked



XL101 Vertical Stacked



L52 Double Truss

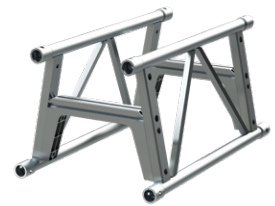

Cable Trunk



L52 Rectangle



Wheel Bracket



60 mm Tube



Stacked L52 Truss

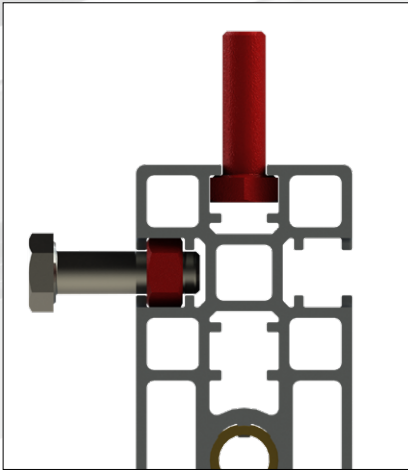

Loading Example:

ALPHA L52S truss with **ALPHA connectors** in the top only, has the same maximum loading capacity as an L52S single straight span or multiple supported span if:

1. The truss modules of the truss span are fully equipped with diagonals between the top chords.
2. The truss span has one diagonal per truss module and is horizontally supported at the top chords every 9 meter.
3. The truss span is horizontally supported at the top every 6 meter.
4. The truss span has equally divided hanging points at a distance of maximum 4.5 meter (multiple supported truss). Example: trusses used for trolley track systems.
5. The truss span is 9 meter long and has one diagonal between the top chords in every truss module.
6. The truss span is 6 meter long.

A reduction of the required loading can result in longer allowable spans, less components and no need for horizontal stabilisation.

Loading capacity of the Alpha Modular Truss System

Trusses designed from the game-changing **Alpha Modular Truss System** can have different sizes and shapes. To get an idea of the loading capacity of ALPHA trusses we highlight the **ALPHA L52S truss**. The ALPHA L52S truss has the same outer dimensions as the well-known welded L52S truss.

Depending on the ALPHA components chosen in the design of an ALPHA L52S truss, its loading capacities can exceed those of a standard L52S. Using a minimum of components for the ALPHA L52S truss may result in lower loading capacity and stability due to a reduced lateral stiffness depending on the length of a truss span, the amount of supports or the type of load. For custom configurations an ALPHA truss needs an individual structural analysis.

Load Capacity Bolt Channel

Type of Bolt Head of Nut	Max Load
M12 Hexagon Bolt Head	600 kg
M12 Hexagon Nut Din 934	600 kg

Values given are for vertical loads only.

Allowable loadings are based on Eurocode EN 1999.

Higher loads are possible. E.g. when square nuts or bespoke inserts are used.

The maximum load shall also be checked in relation with the length of the span of the ALPHA joint.





SIXTY82™

ALPHA⁸²

MODULAR TRUSS SYSTEM

Sixty82 BV

Ampèrelaan 9 | 9207 AM Drachten | The Netherlands

+31 88 13 422 00

info@sixty82.nl

www.sixty82.nl

The New Original

MADE IN THE NETHERLANDS

WORLDWIDE PATENT